



SIDDHI
Mansion
Blue
ELITE LIVING

Luxury living, perfectly connected

In the calm of blue, the city finds its rhythm and luxury discovers its true voice. Each day unfolds endless possibilities, and every journey begins just a step away. Elegant, graceful, and alive with urban energy — modern living reveals itself in timeless shades of blue.





18+
Years

19+
Projects

1.5M+
Built up space

1000+
Happy Families

Transforming Spaces, Enhancing Lives

A legacy of over 17 completed projects defines Siddhi Homes as a trusted builder in Tripunithura. Every project blends quality with elegance, reflecting a promise to create homes that are as enduring as the relationships we build.

തൃപ്പൂണിത്തുറ

Tripunithura - The Royal Address of Culture, Comfort and Connectivity

Tripunithura, the royal city of Kochi, beautifully blends culture, tradition, and modern living. Renowned for its grand festivals and heritage landmarks, it also offers excellent connectivity through the Metro Rail Network. With well-equipped infrastructure, reputed schools, hospitals, and shopping avenues nearby, it stands as a truly complete residential destination.





An Address Above the Ordinary

Mansion Blue rises as a ten-storeyed architectural gem (Basement, Ground, and ten elegant floors) — a serene blend of grace and modernity — redefining premium living near Vadakkekotta Metro Station. Featuring 39 exclusive residences, each floor unfolds two beautifully designed 2BHK and two spacious 3BHK apartments crafted with precision and quiet sophistication. Mansion Blue offers a curated selection of ultra-luxury amenities — including a private home theatre, modern gym, a sophisticated clubhouse, a serene library, and an inviting swimming pool. Every detail reflects refined aesthetics, thoughtful planning, and a sense of calm inspired by blue — shaping a lifestyle that whispers comfort, celebrates elegance, and captures the essence of contemporary urban living.



Project Insight –

An inside view of design, luxury, and life.

40⁺

World Class Amenities & Features

SIDDHI
**Mansion
Blue**
ELITE LIVING

39 Units

A limited collection of exclusive homes, thoughtfully designed to offer unmatched privacy, timeless sophistication, and a close-knit community atmosphere.

10 Floors

Rising gracefully, this single tower premium residence offers stunning views, optimised spaces, and a lifestyle designed for modern living aspirations.

2&3 BHK Unit Options

Experience living spaces tailored for you, with versatile layouts designed to maximise comfort, functionality, and a sense of belonging.

61013 Sq.ft of SBA

An expansive saleable area optimised to deliver seamless living spaces, blending luxury, efficiency, and contemporary design for a truly premium experience.

1246 - 1936 Sq.ft Units

Discover spaciouly designed homes that offer a perfect blend of style, versatility, and elegance to suit your lifestyle needs.

15.17 Ares of Land

Siddhi Mansion Blue seamlessly integrates nature and luxury, creating an exceptional living experience with elegant designs and lush green surroundings.



Amenities & Features –

The Essence of Elegant Living

- Elderly friendly 1 toilet in each apartment
- Automated external Defibrillator in ground floor
- Centralised gas supply
- Provision for EV charging
- Rubber fenders on parking pillars
- Ample green space
- Access for differently abled
- Rainwater harvesting
- 24-hour security/power/water
- Caretaker's room
- Driver's room
- Kids at work
- Library
- Clubhouse
- Landscaped garden
- Multi Recreation hall
- Mini theatre
- Open terrace party area
- Air-conditioned fitness centre
- Guest parking
- Automatic gate
- Janitor's room
- Automated lights at selected common areas
- On-grid solar system for reducing common electricity charges
- One passenger lift and one bed lift
- Video door phone
- International sockets
- Security cameras covering common areas
- Provision for broadband internet connection
- Metal/fibre strip reinforcement on all joints
- Provision for digital TV connection
- Sharp edges avoided on all fabrications for child safety
- Grand entrance lobby
- Piped music in lobby and selected common areas
- Roof top infinity pool
- Garbage disposal system
- Fire safety measures for entire building
- Access point control
- Entry boom barriers
- Maintenance on Call





Siddhi Mansion Blue
Basement
 FLOOR PLAN



Siddhi Mansion Blue
Ground Floor
 FLOOR PLAN

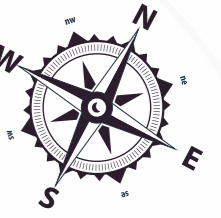





Type A

3 BEDROOM
Floor Plan

SALEABLE AREA	1728 SQ.FT
RERA CARPET AREA	1045 SQ.FT
BALCONY AREA	160 SQ.FT

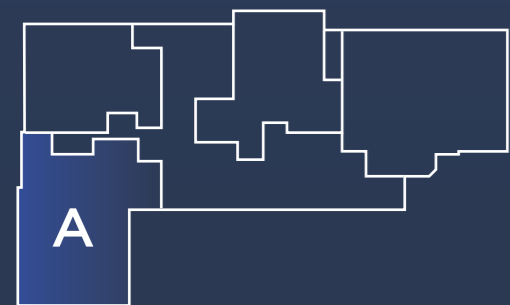

Type B

2 BEDROOM
Floor Plan

SALEABLE AREA	1246 SQ.FT
RERA CARPET AREA	795 SQ.FT
BALCONY AREA	64 SQ.FT

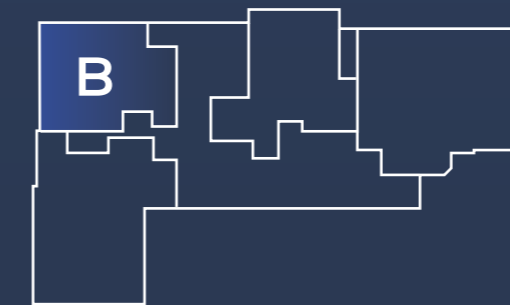

Type C

2 BEDROOM
Floor Plan

SALEABLE AREA	1332 SQ.FT
RERA CARPET AREA	800 SQ.FT
BALCONY AREA	105 SQ.FT

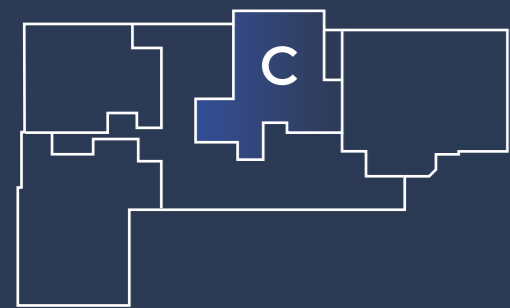

Type C1

2 BEDROOM
Floor Plan - 2nd Floor Only

SALEABLE AREA	1332 SQ.FT
RERA CARPET AREA	800 SQ.FT
BALCONY AREA	105 SQ.FT
OPEN TERRACE AREA	132 SQ.FT

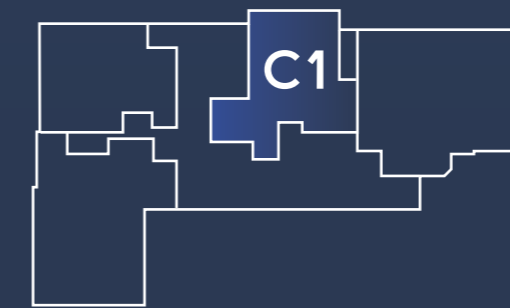

Type D

3 BEDROOM

Floor Plan

SALEABLE AREA	1936 SQ.FT
RERA CARPET AREA	1250 SQ.FT
BALCONY AREA	126 SQ.FT

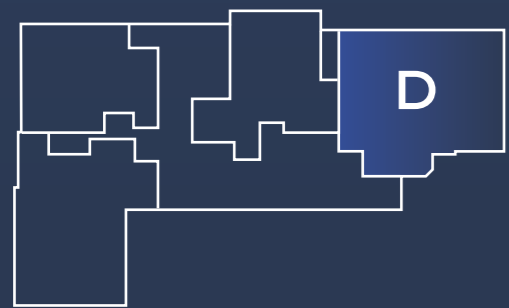

Type D1

3 BEDROOM

Floor Plan - 1st Floor Only

SALEABLE AREA	1861 SQ.FT
RERA CARPET AREA	1195 SQ.FT
BALCONY AREA	126 SQ.FT

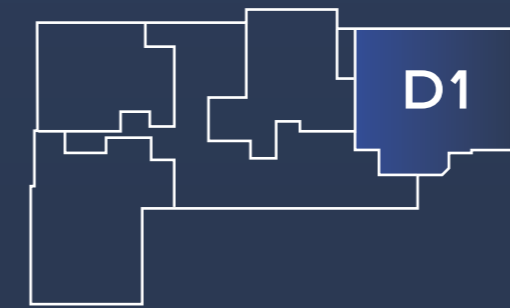

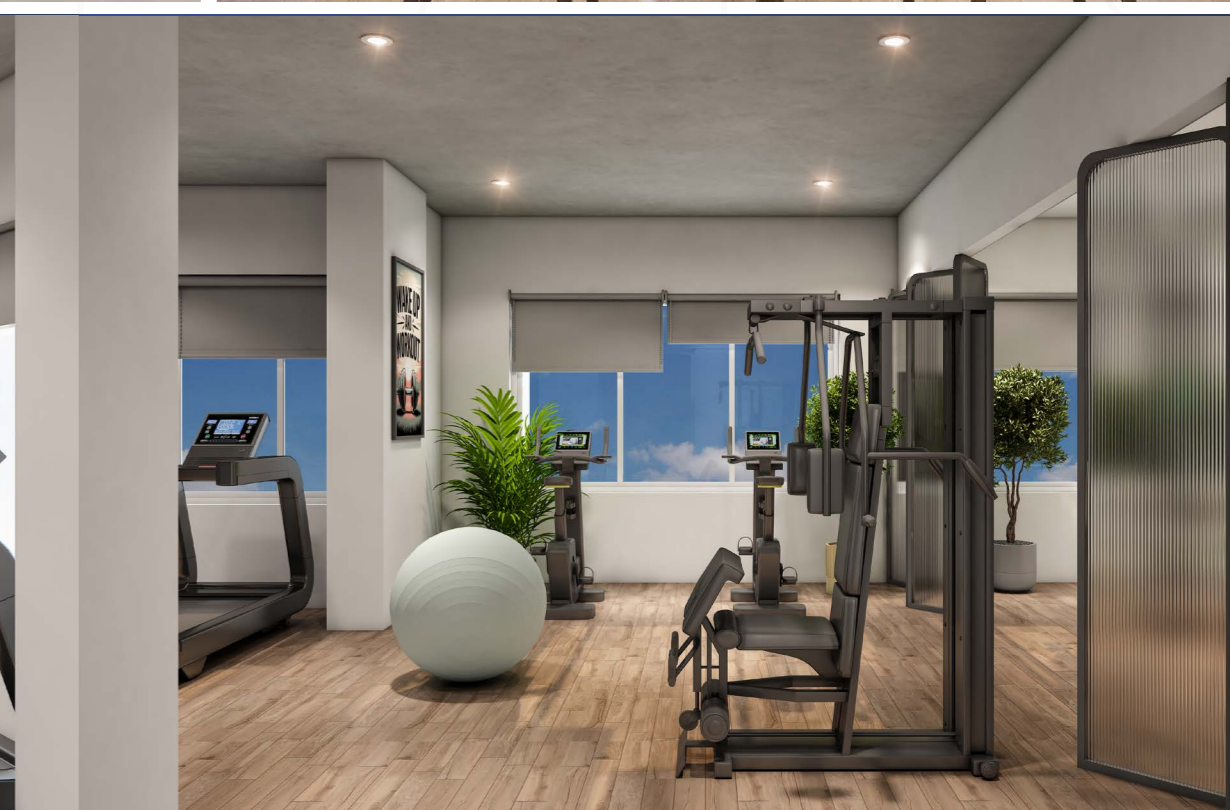

* Artistic Impression





*Artistic Impression







Artistic Impression





Specifications – Every detail built to perfection

	Structure	Pile/ Raft/ Foundation complying with seismic 3 zone Reinforced cement concrete frame with solid cement blocks in walls Earthquake resistant as per IS Standards Concrete grade and steel grade as per structural detailing Internal walls cement plaster with putty and premium emulsion External walls cement plaster and weather shield paint.
	Electrical	All common areas with LED lighting Concealed copper wiring, modular switches, centralized cabling system for all electrical and communication requirements. Modular type switches Generator power back up (1200Watts) for lights, fans and 6 amps plug points except for A/C and Geyser points. Provision for cable TV in living room/Master bedroom.
	Sanitary & Plumbing	Superior quality sanitary ware wall hung EWC with concealed cistern in all toilets, Table top wash basins in dining area and toilets with concealed cistern. Faucets and CP Fixtures. Single lever concealed diverters in all toilets of premium quality. All water supply lines shall be in ISI marked ASTM pipes.
	Doors & Windows	Decorative paneled main door in teak wood finish with Melamine polish. Branded pre-hung door with engineered door frame for internal doors. Both side laminated with PU coating and PVC wrapped door frame for toilets. Best quality hardware for all doors. Windows are fully glazed UPVC/ Aluminium windows of superior quality with MS grills wherever required.
	Flooring	Best quality vitrified tiles for living room, dining room, bedrooms. Kitchen, work area and balcony with rustic finish tiles. Toilet wall tiles upto false ceiling. Anti-skid matt floor tiles- ceramic/rectified tiles for balcony and toilets. Entrance lobby, staircase and common areas will be of granite/vitrified tiles.

Brand Pool – Excellence Chosen from the Best



Location Highlights

A Prestigious Address with Royal Heritage.

TRANSIT DESTINATIONS

Metro Station	0.1 kms
Vytilla Mobility Hub	3.6 kms
Thripunithura Railway Station	2.0 kms
Ernakulam South Railway Station	7.2 kms
Water Metro	3.6 kms

HOSPITAL

VKM Hospital	0.4 kms
Varma Hospital	0.6 kms
Devi Hospital	1.0 kms
Welcare Hospital	3.7 kms
Lakeshore Hospital	6.0 kms

EDUCATIONAL INSTITUTIONS

The Choice School	2.0 kms
NSS Higher Secondary School	1.5 kms
Bhavan's Vidya Mandir	2.5 kms
St. Joseph English Medium	1.5 kms
Chinmaya College	1.3 kms

BUSINESS HUB

Infopark Kochi	9.0 kms
CSEZ	9.0 kms

COMMERCIAL HUB

Nucleus Mall	2.1 kms
Forum Mall	3.7 kms
Central Takies	1.6 kms

RELIGIOUS

Poornathrayeesa Temple	1.3 kms
St. Joseph Catholic Church	0.1 kms
Petta Masjid	0.5 kms

*The maps provided are for reference only and may not reflect exact boundaries, routes, or precise distances to key landmarks and facilities.



Call: +91 9645 699 000

K-RERA/PRJ/ERN/024/2026



SIDDHI HOMES PROJECTS PVT. LTD

Corporate Office: 39/141 A1, Ground Floor, Siddhi Sreekala,
Near Vadakkekotta Metro Station, Tripunithura, Kochi - 682 301
sales@siddhihomes.com | siddhihomes.com

Disclaimer: This brochure is conceptual and not a legal offering. All images are for illustrative purposes only. Siddhi Homes Projects Pvt. Ltd reserves the right to change, delete, or add any specifications or plans mentioned herein. Additionally, Siddhi Homes Projects Pvt. Ltd reserves the right to modify the brand pool in the event of non-availability of a particular brand mentioned in the brochure.